



Garden Flat, 46B Mount Pleasant Terrace, Southville, Bristol, BS3 1LF

£235,000

Hollis Morgan - This well presented garden flat is located yards away from the ever popular and vibrant North St with its exciting array of independent shops, cafes, bars and restaurants

The Property

This light and airy newly refurbished garden flat located within a short walk of Southville's vibrant and popular North St, home to a vast array of local and independent retailers, cafes and restaurants.

Access to the property is gained via a private entrance which beckons you via a hallway into a bright living space, a stylish fully fitted shower room has been cleverly incorporated into the accommodation complete with electric shower, low level W.C and wash basin. A well proportioned double bedroom with ample storage overlooks the courtyard. Completing the footprint, a sleek fully fitted kitchen with integrated fridge/freezer, dishwasher, electric hob, oven and washer/dryer. In addition there is direct access to an enclosed courtyard, perfect for entertaining.

Ample on- street residents parking is available via Bristol City Council with a permit.

Location

Mount Pleasant is located within the popular suburb of Southville. North Street is moments away and offers a wide variety of amenities including bars, pubs, cafes and independent retailers. Bristol City Centre and the Harbourside district is within a mile whilst there are also regular public transport links running from Bedminster to the Cabot Circus shopping complex which is approximately two miles away.

Other Information

Leasehold residue of 999 years.

Management Fee: Please refer to agent.

Council Tax Band: B

Please Note

We endeavour to make our sales details accurate and reliable but they should not be relied on as statements or representations of fact and they do not constitute any part of an offer or contract. The seller does not make any representation or give any warranty in relation to the property and we have no authority to do so on behalf of the seller.





Mount Pleasant Terrace, Bristol, BS3

Approximate Area = 508 sq ft / 47.2 sq m

For identification only - Not to scale

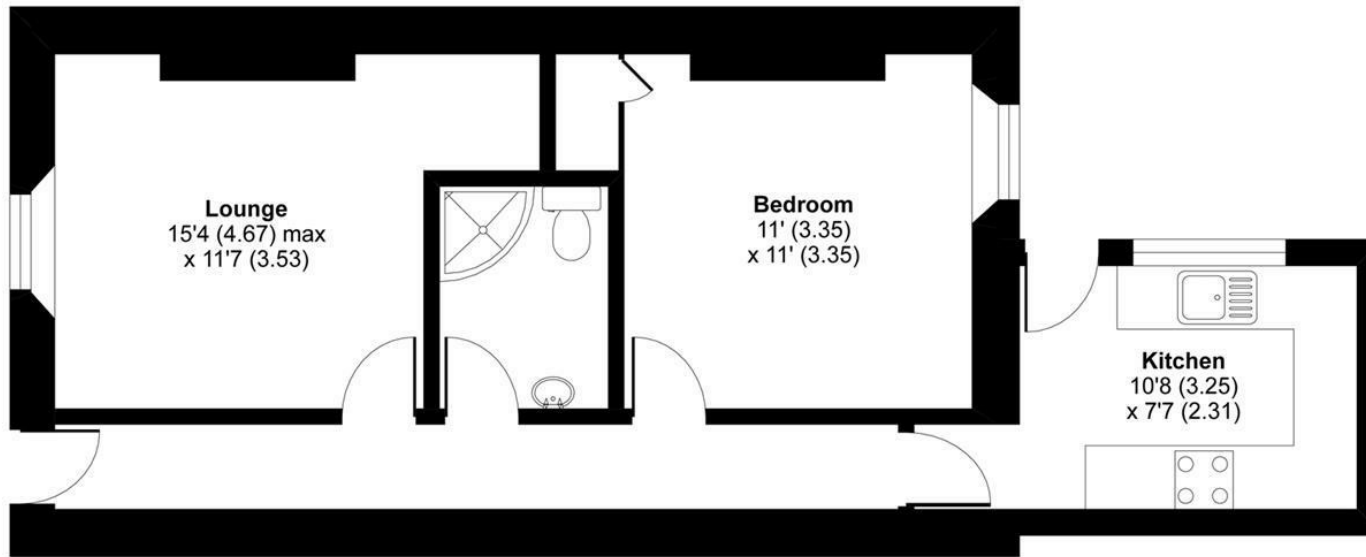

GROUND FLOOR



Floor plan produced in accordance with RICS Property Measurement Standards incorporating International Property Measurement Standards (IPMS2 Residential). © n'checon 2020. Produced for Hollis Morgan. REF: 611277

e-mail: post@hollismorgan.co.uk www.hollismorgan.co.uk

9 Waterloo Street, Clifton, Bristol BS8 4BT. Telephone: 0117 973 65 65

Hollis Morgan Property Limited, registered in England, registered 7275716. Registered address, 5 Upper Belgrave Road, Clifton, Bristol BS8 2XQ

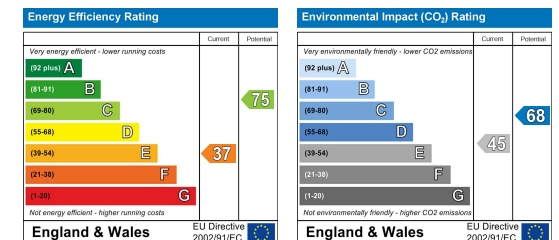

hollis
morgan
